

## Slow Blow Brick Fuse 1040TD Series

### Description

- ▶ Slow blow surface-mount fuse
- ▶ Designed according to IEC60127-4
- ▶ Solder immersion compatible

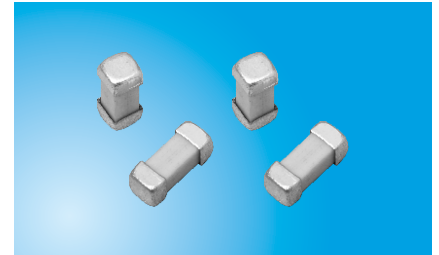

### Features

- ▶ 250VAC voltage rating
- ▶ Slow blow
- ▶ RoHS compliant
- ▶ Fully compatible with lead-free solder alloys and higher temperature profiles associated with lead free assembly

### Applications

- ▶ Lighting ballast
- ▶ AC/DC adaptor primary protection
- ▶ Transformerless AC/DC converter circuit
- ▶ High dc voltage power distribution system

## Slow Blow Brick Fuse 1040TD Series

### Dimensions(mm)

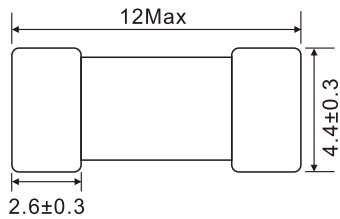

### Recommended Pad Layout(mm)

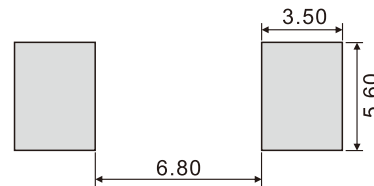

### Electrical Specifications

Catalog Number	Ampere Rated In	Marking	Voltage Rating(VDC)	Normal Resistance Cold(Ohm)	Normal Melting I <sup>2</sup> T(A <sup>2</sup> sec)	Voltage Drop(mv)
1040TD500mA	500mA	T0.5	250V	0.227	0.43	160
1040TD630mA	630mA	T0.63	250V	0.157	0.80	160
1040TD800mA	800mA	T0.8	250V	0.130	1.40	160
1025TD1A	1A	T1	250V	0.0867	2.70	140
1040TD1.25A	1.25A	T1.25	250V	0.0602	5.20	130
1040TD1.6A	1.6A	T1.6	250V	0.0443	9.70	130
1040TD2A	2A	T2	250V	0.0335	5.44	120
1040TD2.5A	2.5A	T2.5	250V	0.0278	8.00	120
1040TD3.15A	3.15A	T3.15	250V	0.0204	14.0	110
1040TD4A	4A	T4	250V	0.0158	21.0	110
1040TD5A	5A	T5	250V	0.0124	40.0	110

## Slow Blow Brick Fuse 1040TD Series

### Electrical Characteristics

Electrical Characteristics		
Ampere Rating	% of Amp Rating	Opening Time
500mA-5A	125%	1 Hours Minimum
	200%	120 Seconds Maximum
	1000%	10ms Minimum

### Temperature Rerating Curve

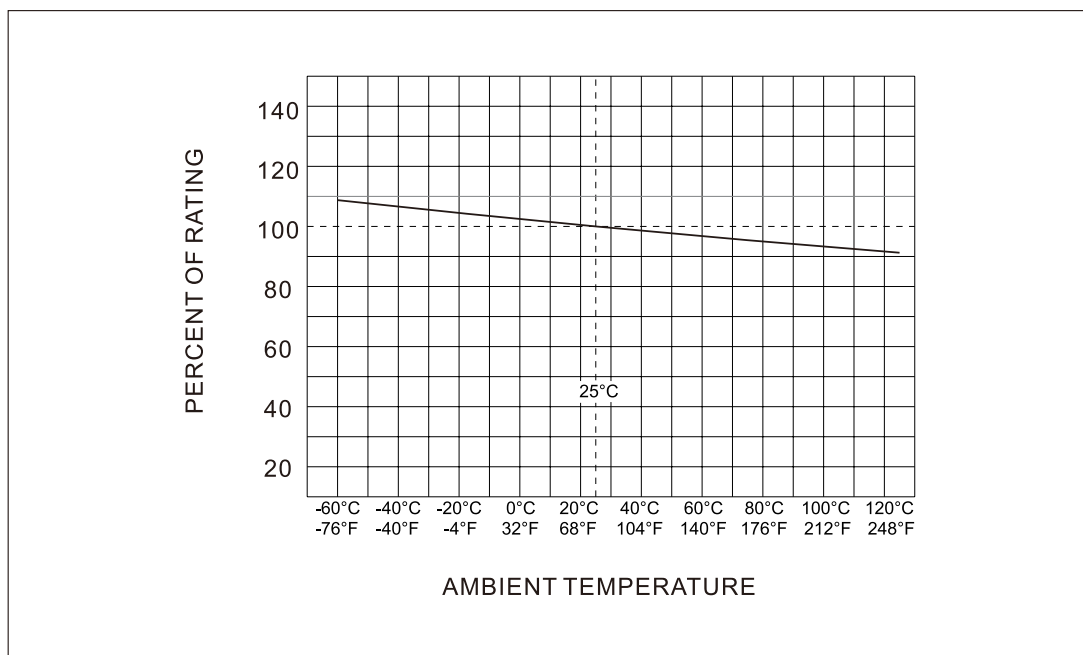

#### Note:

- ▶ Rerating depicted in this curve is in addition to the standard derating of 25% for continuous operation.

**Slow Blow Brick Fuse 1040TD Series**

**Time-Current Characteristics**

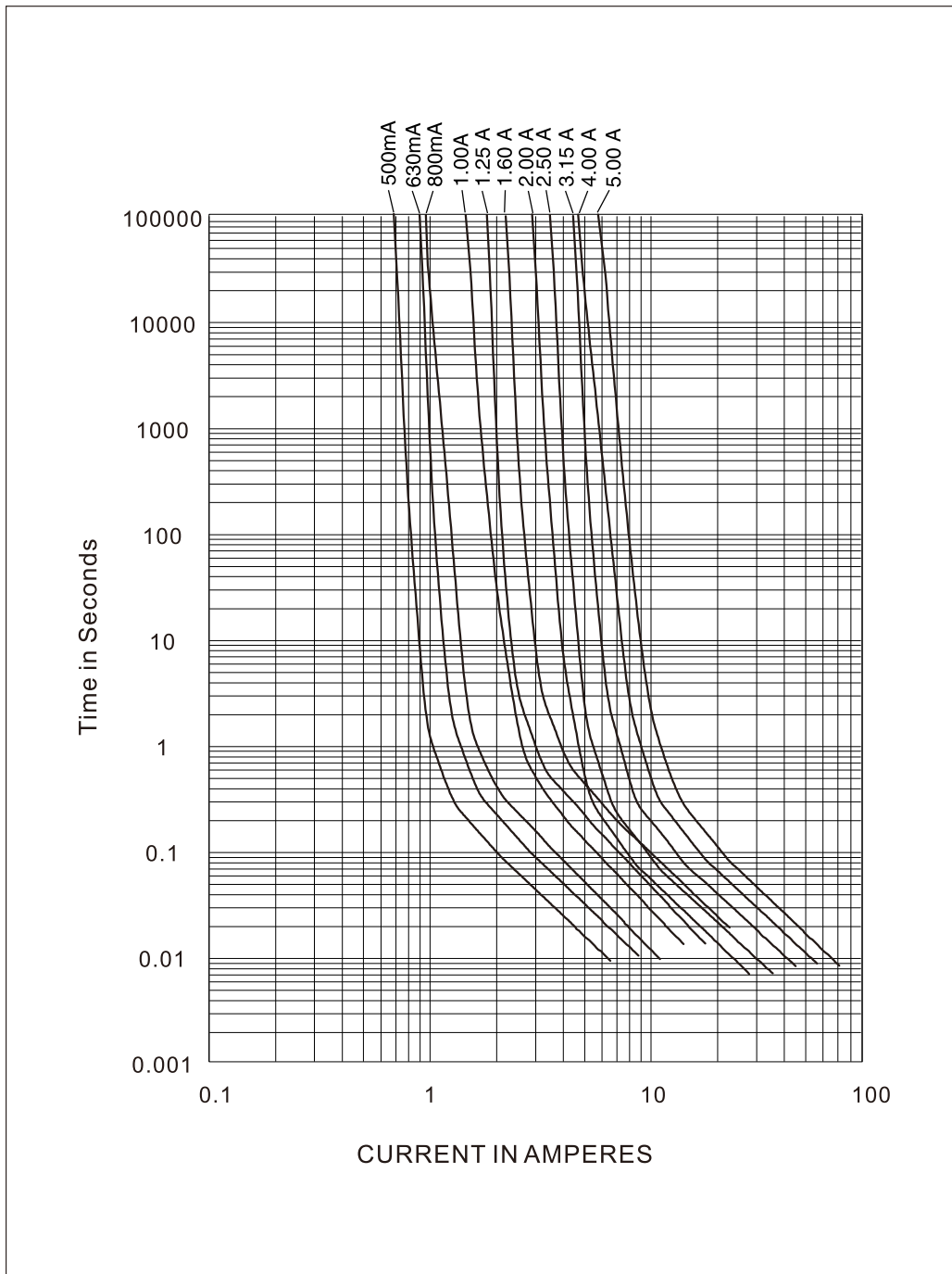

## Slow Blow Brick Fuse 1040TD Series

### Soldering Parameters

Reflow Condition		Pb- Free assembly
Heat Pre	Temperature Min( $T_s$ )	150°C
	Temperature Max( $T_s$ )	200°C
	Time (Min to Max)( $t_s$ )	60 -120 secs
Average ramp up rate (Liquidus)Temp ( $T_L$ ) to peak		3°C/second max
$T_s$ (max) to $T_L$ -Ramp-up Rate		3°C/second max
Reflow	- Temperature ( $T_L$ ) (Liquidus)	217°C
	Time (Min to Max) ( $t_L$ )	60-90 seconds
Peak Temperature ( $T_p$ )		260 <sup>+0/-5</sup> °C
Time within 5°C of actual peak Temperature ( $t_p$ )		20-40 seconds
Ramp-down Rate		5°C/second max
Time 25°C to peak Temperature ( $T_p$ )		8 minutes max.
Do not exceed		260°C

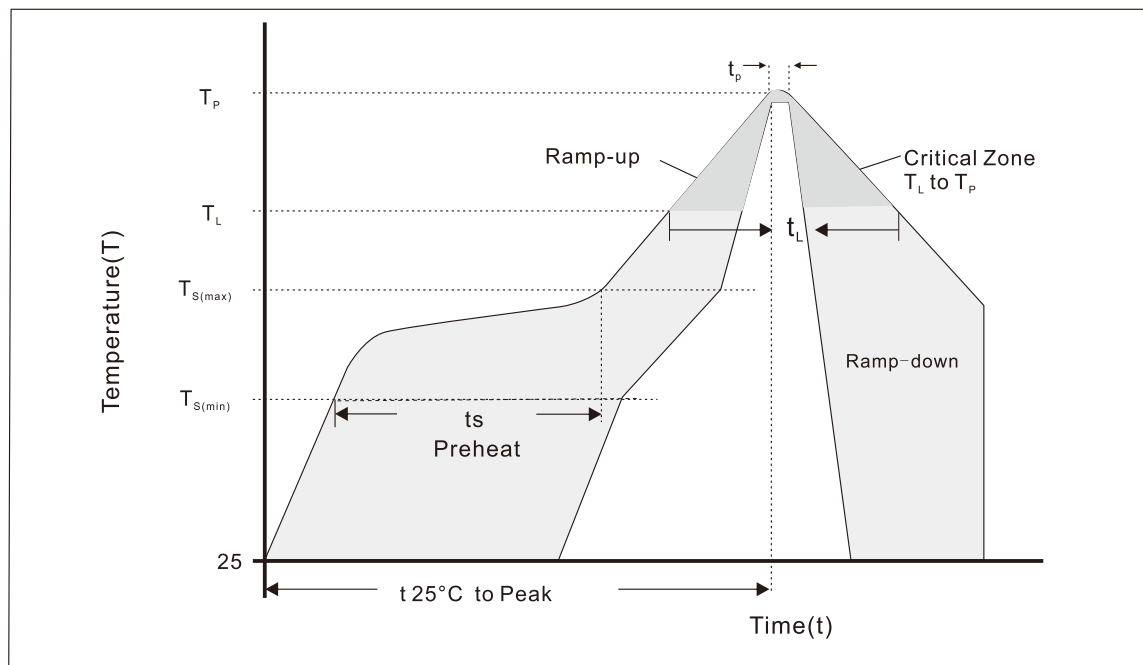

## Slow Blow Brick Fuse 1040TD Series

### BC performance

PN	BC	
	DC	AC
1040TD500mA-4A	DC250V/100A	AC350V/100A
1040TD500mA-4A	DC250V/150A	AC250V/150A
1040TD5A	DC250V/150A	AC250V/150A

### Operation Temperature

- ▶ -40°C to 125°C

### Physical Specification Materials

- ▶ Ceramic Body/Metallization of ceramic body
- ▶ Fuse Element:copper or copper Alloy
- ▶ End plate:copper
- ▶ High temperature solder preform
- ▶ Filler:Molecular sieve

### Packaging

- ▶ On Tape:1040TD-1000pcs Per Reel
- ▶ 1040TD-6000pcs outer box